

Fiber Optic Multiport Service Terminals

LB-MST / LB-P2P-MST Series

**LINDSAY
BROADBAND**
a division of technetix group

Lindsay Broadband's FiberHub® multiport splitter service access terminals incorporate hardened adapters and enable rapid tower and indoor/outdoor fiber to the home (FTTH) deployments. Terminals are available in different configurations similar to an RF tap. LB-MSTs are available in terminated or unterminated, point-to-point or using MPO connections for indexing (add/drop-style) configurations. These terminals are IP68 rated to withstand the rigors of outdoor deployments in all environments. Terminals can be mounted in a vault, pedestal, pole or on a strand. Each terminal comes with a mounting kit allowing aerial mounting. For other types of mounting kits, please contact the factory.



LB-P2P-MST-12 port
(front angled view)

FEATURES

- Available in a variety of options (terminated, unterminated, point-to-point or MPO indexing)
- Hardened connectors are factory-terminated & environmentally sealed for use in optical drop cable deployments
- Plug-and-play adapter ports ensure rapid cable installation
- Incorporated hardened connector technology that is designed to withstand the rugged outside plant (OSP) environment
- IP68 rated, high quality, high performance connectors
- Flexible Choice of Ports: 2, 4, 6, 8, 12 or 16
- Mounting Configurations: Aerial, wall or buried
- Compatible with industry standard drop cables & connectors
- Option of factory spliced feed cable in MST or a female connector on MST for feed cable

MECHANICAL SPECIFICATIONS DIAGRAM (2-PORT MST)

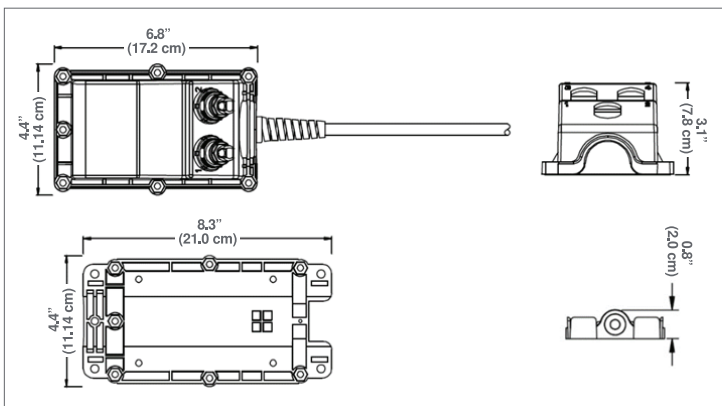

2-port, 4-port & 8-port LB-MST-70/30 &
LB-MST-MPO (side views)

MECHANICAL SPECIFICATIONS DIAGRAM (4-PORT MST)

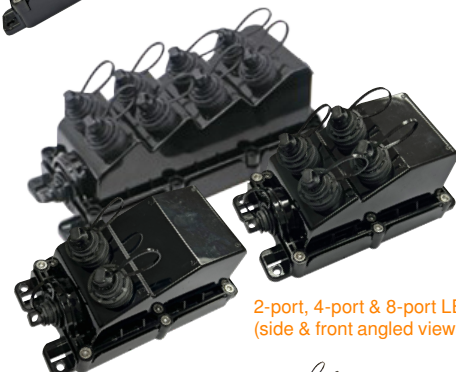
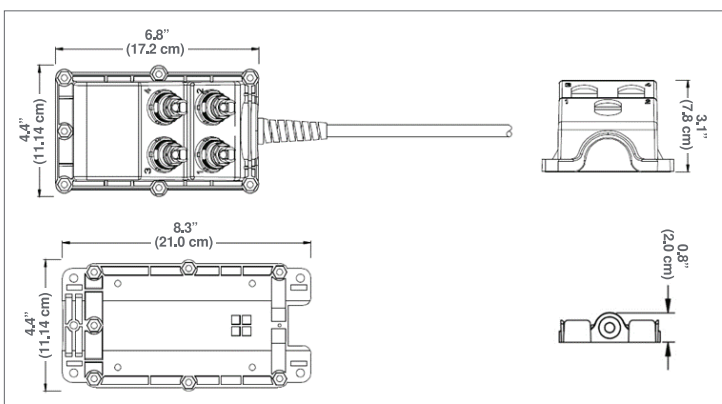

2-port, 4-port & 8-port LB-MST-T
(side & front angled views)



16-port LB-MST
(front angled view)

MECHANICAL SPECIFICATIONS DIAGRAM (8-PORT MST)

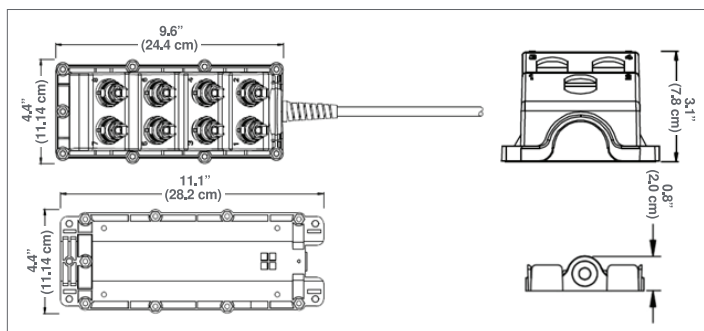

MECHANICAL SPECIFICATIONS DIAGRAM (12-PORT P2P MST)

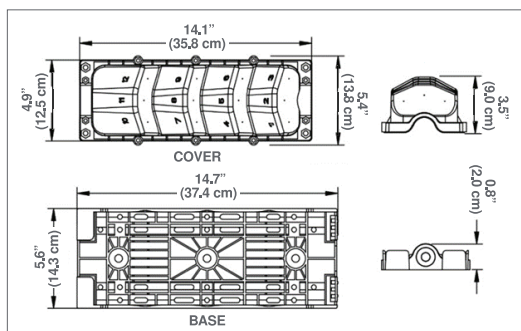

MECHANICAL SPECIFICATIONS DIAGRAM (16-PORT MST)

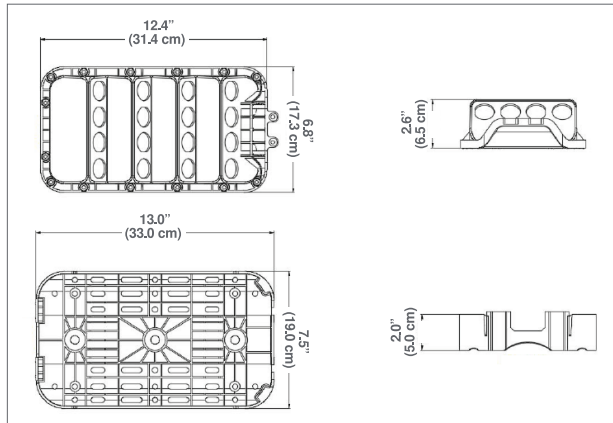

SPECIFICATIONS

Parameter	Specification
Ports	2, 4, 6, 8, 12 & 16
IP Rating	IP68
Material	ML6411 reinforced polycarbonate + ABS & stainless steel 304
RoHS Compliant	Yes
Connectors	SuperTap SC/APC connector or SuperTap MPO connector
Entrance	SuperTap adapter
Feed Cable	1 core for MST, 12 core for MPO MST & 2, 4, 6, 8 or 12 core options for P2P-MST
Feed Cable Length	Customizable - see ordering information. Also available without feed cable connected
1x2 FBT 70/30 Coupler	70% = 2.5 dB IL (max.); 30% = 6.5 dB IL (max.)
1x2 PLC Splitter	4.1 dB IL (max.)
1x4 PLC Splitter	7.4 dB IL (max.)
1x8 PLC Splitter	10.5 dB IL (max.)



SPECIFICATIONS CONT'D.

Parameter		Specification
1x16 PLC Splitter		14.5 dB IL (max.)
1x2 FBT 70/30 Coupler + 1x2 PLC Splitter		70% output = 2.5 dB IL (max.) 30% drop + 1x2 PLC splitter output = 10.6 dB IL (max.)
1x2 FBT 70/30 Coupler + 1x4 PLC Splitter		70% output = 2.5 dB IL (max.) 30% drop + 1x4 PLC splitter output = 13.9 dB IL (max.)
1x2 FBT 70/30 Coupler + 1x8 PLC Splitter		70% output = 2.5 dB IL (max.) 30% drop + 1x8 PLC splitter output = 17.0 dB IL (max.)
1x2 FBT 70/30 Coupler + 1x16 PLC Splitter		70% output = 2.5 dB IL (max.) 30% drop + 1x16 PLC splitter output = 21.0 dB IL (max.)
Mounting Method		Strand, pole, wall, handhole or pedestal
Cable		
Cable Type		Dielectric flat loose tube cable or round cable
Cable Size		4.5 x 8.1 mm (0.18" x 0.32") or 5.0 mm (0.2")
Cable Length		See ordering information
Feed Cable		1 core for MST, 12 core for MPO MST & 2, 4, 6, 8 or 12 core options for P2P-MST
Attenuation (Max.)	@ 1310 nm	0.40 dB/km
	@ 1550 nm	0.30 dB/km
Directivity (Max.)		60 dB
Wavelength Range		1260-1635 nm
Insertion Loss (Max.)	SuperTap Terminal Connector	0.4 dB
Return Loss (Min.)	Connector	65 dB
Environmental & Physical		
Operating Temperature		-40°C to +85°C (-40°F to +185°F)
Dimensions (H x W x D)	2 Ports	8.3"H x 4.4"W x 3.9"D (21.0H x 11.14W x 9.8D cm)
	4 Ports	8.3"H x 4.4"W x 3.9"D (21.0H x 11.14W x 9.8D cm)
	8 Ports	11.1"H x 4.4"W x 3.9"D (28.2H x 11.14W x 9.8D cm)
	12 Ports	14.7"H x 5.6"W x 4.3"D (37.4H x 14.3W x 11.0D cm)
	16 Ports	13.0"H x 7.5"W x 4.5"D (33.0H x 19.0W x 11.5D cm)
Weight	2 Ports	1.4 lb (0.6 kg)
	4 Ports	1.7 lb (0.8 kg)
	8 Ports	2.0 lb (0.9 kg)
	12 Ports	4.7 lb (2.1 kg)
	16 Ports	3.1 lb (1.4 kg)

ORDERING INFORMATION (LB-MST)

Port & Splitter Configuration		Type	Feed Cable Length
LB-MST	xxx	x	xxxx
102 = 2 ports with 1x2 splitter		T = Terminated	00000 = No feed cable
104 = 4 ports with 1x4 splitter		70/30 = Unterminated with a pass through coupled at 70/30 ratio	100F = 100' (30.5 m)
108 = 8 ports with 1x8 splitter		MPO = Indexing MPO-style. 12 MPO connector for input & pass through	200F = 200' (61 m)
108x2 = 16 ports with two 1x8 splitters ⁽¹⁾			300F = 300' (91.4 m)
116 = 16 ports with 1x16 splitter			500F = 500' (152.4 m)
			600F = 600' (182.9 m)
			800F = 800' (243.8 m)
			1000F = 1000' (304.8 m)

NOTE:

(1) This configuration only available with MPO indexing-style type

EXAMPLES:

Part # LB-MST-102-T

2-port MST fiber hub closure terminated with a 1x2 PLC splitter

Part #LB-MST-104-70/30

4-port MST fiber hub closure with a 70/30 coupled output port & a 1x4 PLC splitter

Part # LB-MST-108-MPO

8-port MST fiber hub enclosure indexing-type with MPO input & output connectors & 1x8 PLC splitter



Terminated LB-MST with 1x2, 1x4 or 1x8 splitters (LB-MST-xxx-T)

ORDERING INFORMATION (LB-P2P-MST)

LB-P2P-MST	# of Ports	Feed Cable Length
	xx	xxxx
	02 = 2 ports	100F = 100' (30.5 m)
	04 = 4 ports	200F = 200' (61 m)
	06 = 6 ports	300F = 300' (91.4 m)
	08 = 8 ports	500F = 500' (152.4 m)
	12 = 12 ports	600F = 600' (182.9 m)
		800F = 800' (243.8 m)
		1000F = 1000' (304.8 m)

EXAMPLE:

Part # LB-P2P-MST-12-100F

Point-to-point MST fiber hub enclosure with 12 ports & 100' (30.5 m) length 12-fiber feed cable



LB-P2P-MST-12 port with cable feed

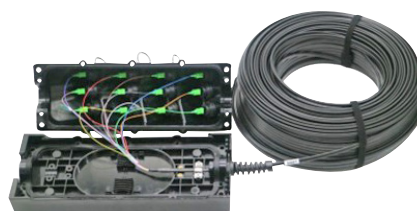

LB-P2P-MST-12 port with cable feed (open)

ACCESSORY ORDERING INFORMATION (LB-FD FEED & DROP CABLES)

LB-FD	Cable Type	Connector #1	Connector #2	Cable Length
	x	ST	xx	xxxx
	X = 4.5 x 8.1 mm dielectric cable R = 5.0 mm round cable	ST = SuperTap SC/APC connector	00 = No connector (pigtail) ST = SuperTap SC/APC connector SA = Regular SC/APC connector	50F = 50' (15.2 m) 100F = 100' (30.5 m) 200F = 200' (61.0 m) 300F = 300' (91.4 m) 400F = 400' (121.9 m) 500F = 500' (152.4 m) 600F = 600' (182.9 m) 800F = 800' (243.8 m) 1000F = 1000' (304.8 m)

EXAMPLE:

Part # LB-FD-X-ST-00-100F

4.5 x 8.1 mm dielectric flat drop cable with SuperTap SC/APC connector on one end, other end unterminated, 100' (30.5 m) length, for use with LB-FST & LB-MST

ACCESSORY ORDERING INFORMATION (LB-MPOC INDEXING-STYLE FEED CABLES)

LB-MPOC	Connector #1	Connector #2	Cable Length
	STMPO	xxxx	xxxx
	STMPO = SuperTap MPO connector male STMPOF = SuperTap MPO connector female	STMPO = SuperTap MPO connector male STSA = 12 standard SC/APC connectors	50F = 50' (15.2 m) 100F = 100' (30.5 m) 200F = 200' (61.0 m) 300F = 300' (91.4 m) 400F = 400' (121.9 m) 500F = 500' (152.4 m) 600F = 600' (182.9 m) 800F = 800' (243.8 m) 1000F = 1000' (304.8 m)

EXAMPLE:

Part # LB-MPOC-STMPO-STSA-100F

12-fiber cable with SuperTap MPO male connector on one end, to 12-fiber standard SC/APC connectors on other end, 100' (30.5 m) length, for use with LB-MST

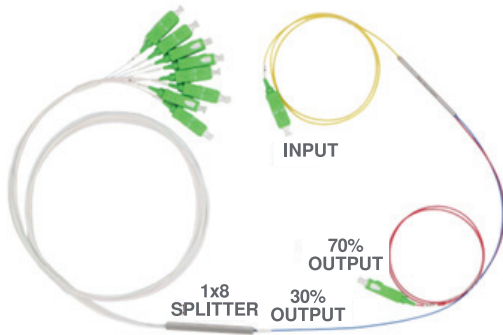

Underterminated 8-port LB-MST 1x2 70/30 coupler with 1x8 splitter (LB-MST-108-70/30)

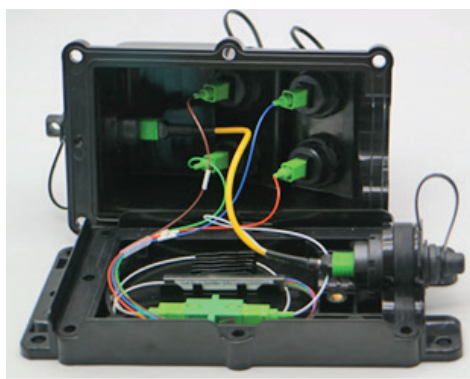

MPO indexing-style MST closure (LB-MST-xxx-MPO)

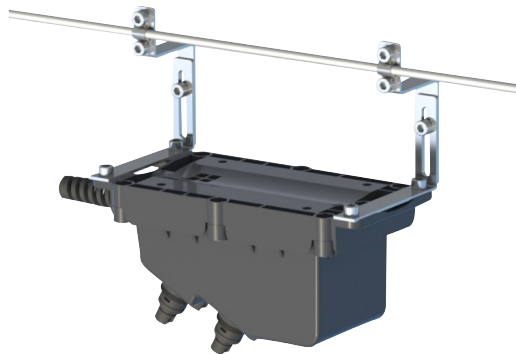
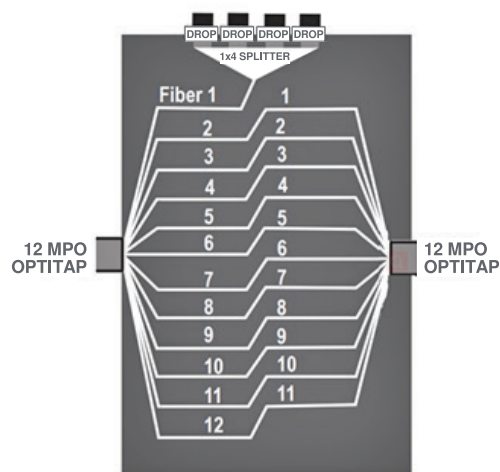

LB-MST aerial or strand mounting (kit included)



LB-MST pole mounting



LB-MST wall mounting